

Flange Rings

FR0001

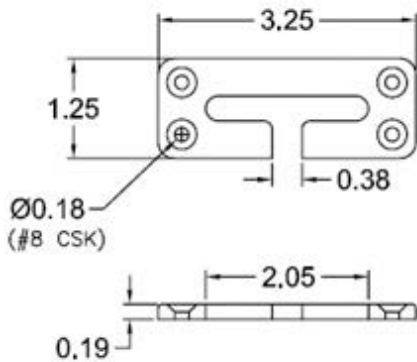

FR0001 Seat-Belt Trim

- 1) Finish: Available polished or ball-burnished.
- 2) Use to trim around the cut-out needed or squad bench for the seat-belt strap.

FR0006

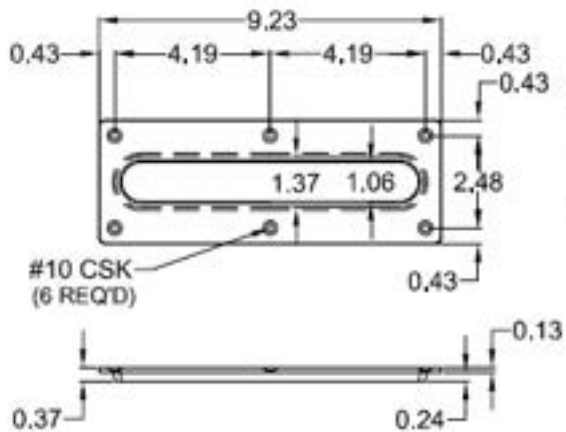

FR0006 Slot Plate

- 1) Finish: Polished.

FR0009

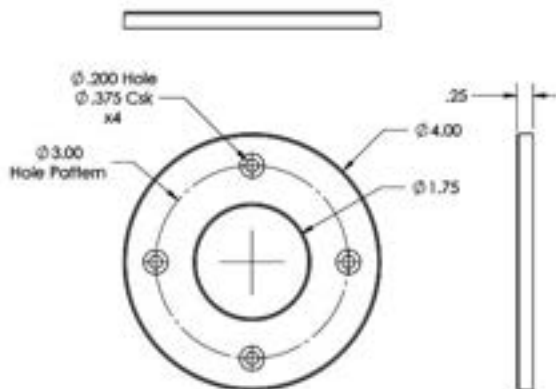

FR0009 Flange Ring 1.75" ID x 4.0" OD

- 1) Finish: Polished exterior.

FR0010

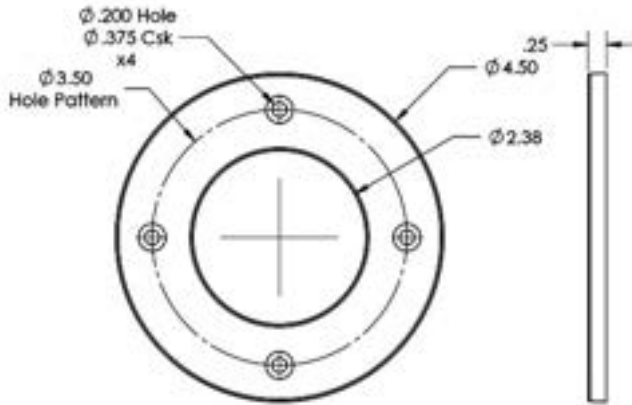

FR0010
Flange Ring
2.38" ID x 4.50" OD

1) Finish: Polished exterior.



FR0011

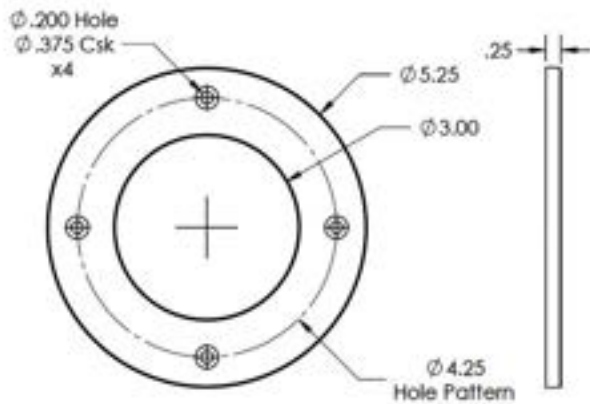

FR0011
Flange Ring
3.0" ID x 5.25" OD

1) Finish: Polished exterior.



FR0012

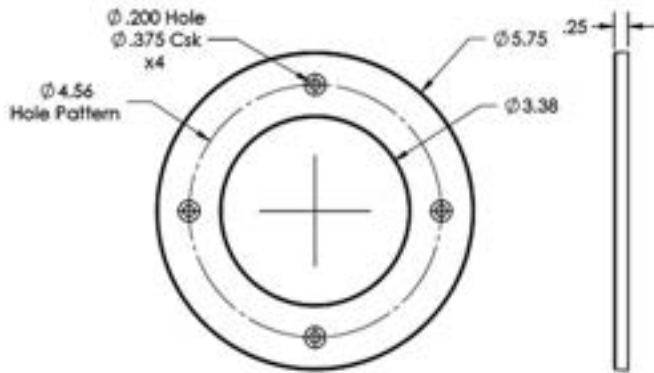

FR0012 Flange Ring 3.38" ID x 5.75" OD

1) Finish: Polished exterior.



FR0013

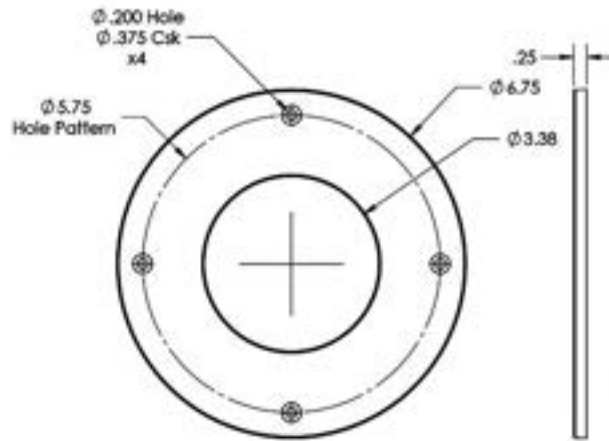

FR0013 Flange Ring 3.38" ID x 6.75" OD

1) Finish: Polished exterior.



FR0014

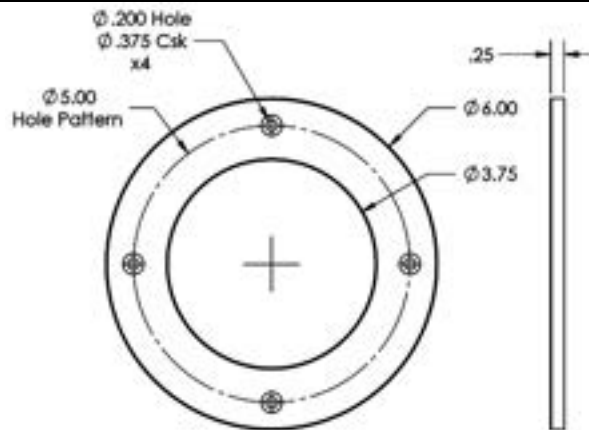

FR0014 Flange Ring 3.75" ID x 6.0" OD

1) Finish: Polished exterior.



FR0015

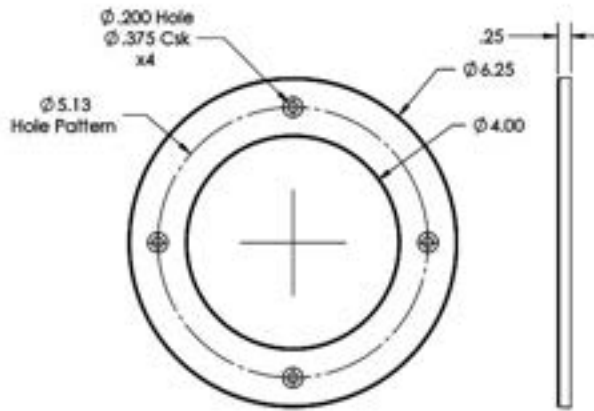

FR0015 Flange Ring 4.0" ID x 6.25" OD

1) Finish: Polished exterior.

FR0021

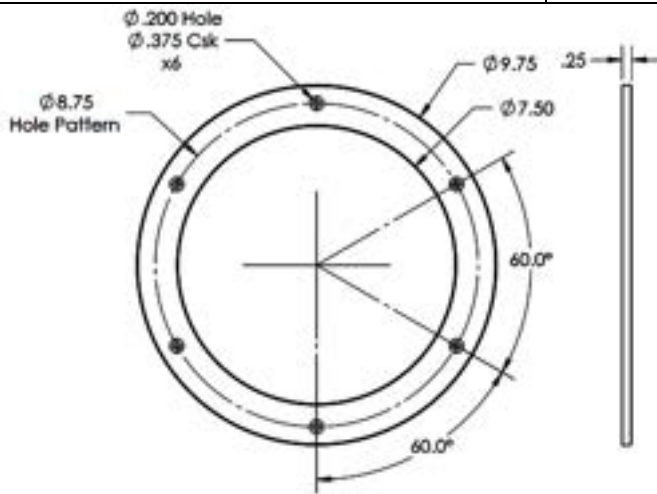

FR0021 Flange Ring 7.50" ID x 9.75" OD

1) Finish: Polished exterior.

FR0022

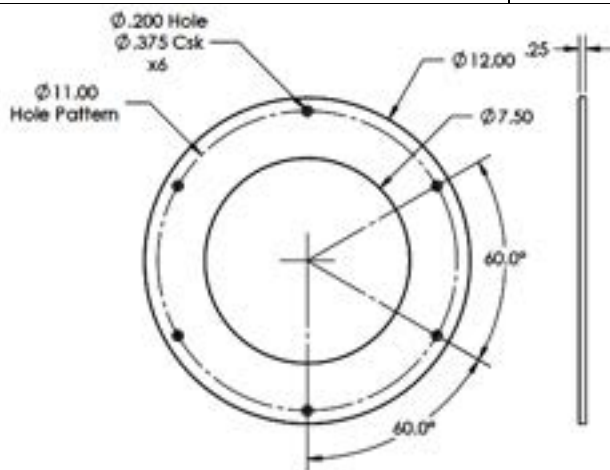

FR0022 Flange Ring 7.50" ID x 12.0" OD

1) Finish: Polished exterior.

FR0025

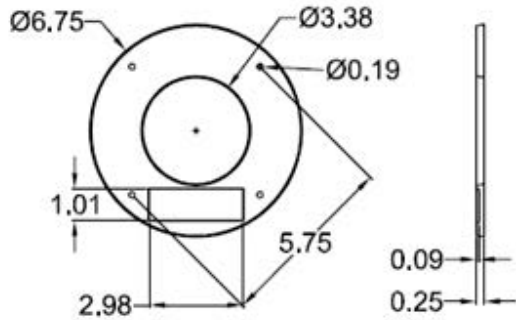

FR0025
Flange Ring w/ Tag
Recess (3 3/8" ID)

1) Finish: Polished.

FR0026

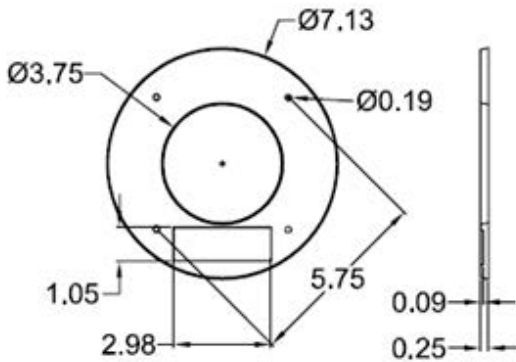

FR0026
Flange Ring w/ Tag
Recess (3 3/4" ID)

1) Finish: Polished.

FR0027

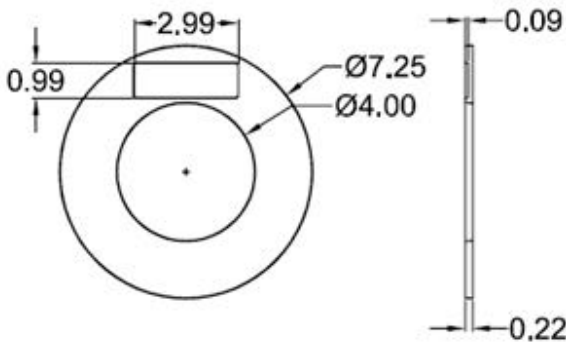

FR0027
Flange Ring w/ Tag
Recess (4" ID)

1) Finish: Polished.

FR0028

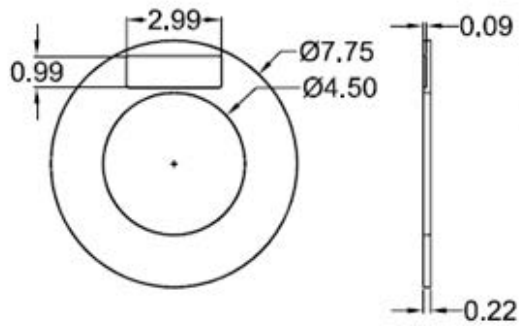

FR0028
Flange Ring w/ Tag
Recess (4 1/2" ID)

1) Finish: Polished.

FR0029

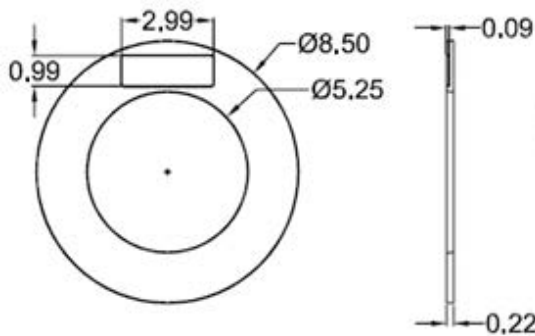

FR0029
Flange Ring w/ Tag
Recess (5 1/4" ID)

1) Finish: Polished.

FR0030

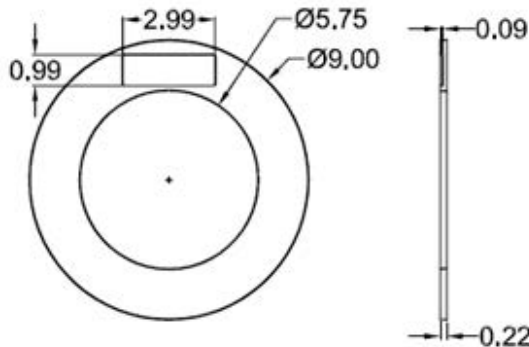

FR0030
Flange Ring w/ Tag
Recess (5 3/4" ID)

1) Finish: Polished.

FR0047

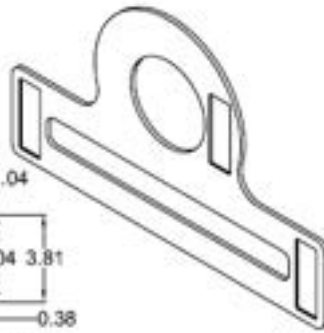
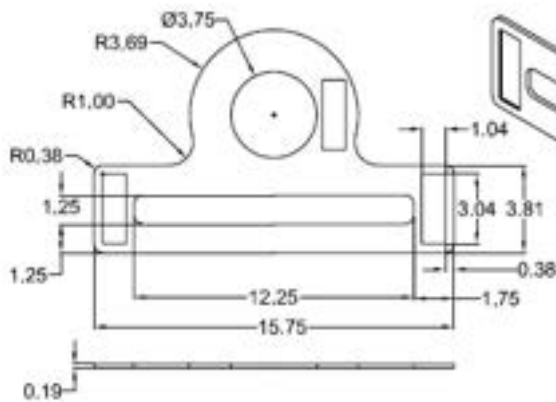

FR0047
**Pump Panel Trim w/
Tag Recess (Right
Side)**

- 1) Finish: Polished.
- 2) Material: 6061-T6 Aluminum

FR0048

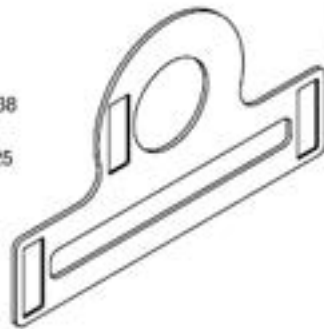
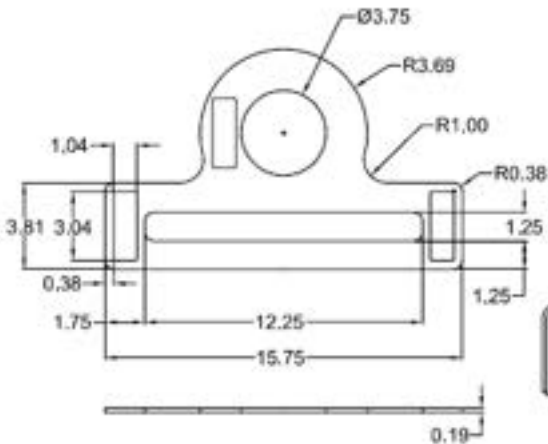

FR0048
**Pump Panel Trim w/
Tag Recess
(Left Side)**

- 1) Finish: Polished.
- 2) Material: 6061-T6 Aluminum

FR0049

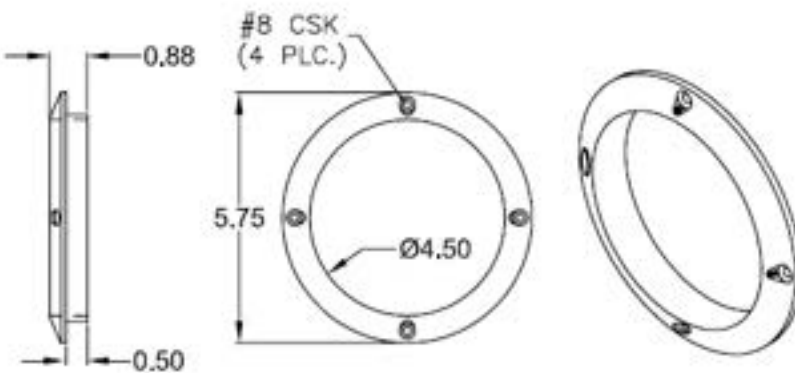

FR0049
**Oxygen Bottle Floor
Trim Ring**

- 1) Finish: Polished.

FR0051

FR0051

**Flange Ring, 10.62 ID
x 14.50 OD**

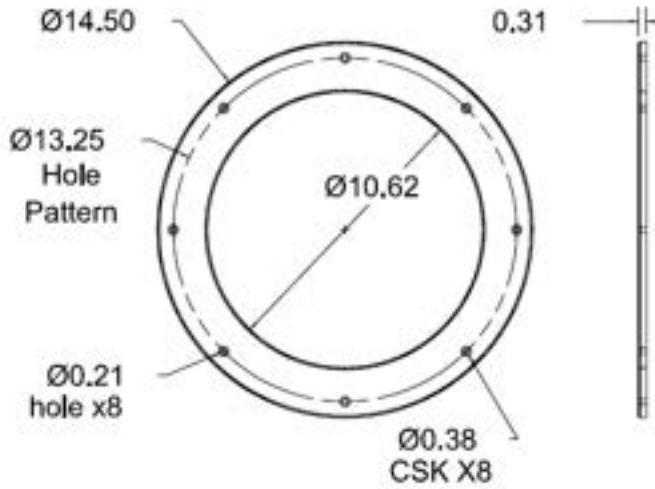

1) Finish: Polished.



FR0052

FR0052

**Flange Ring, 2.75 OD
x .53 ID**

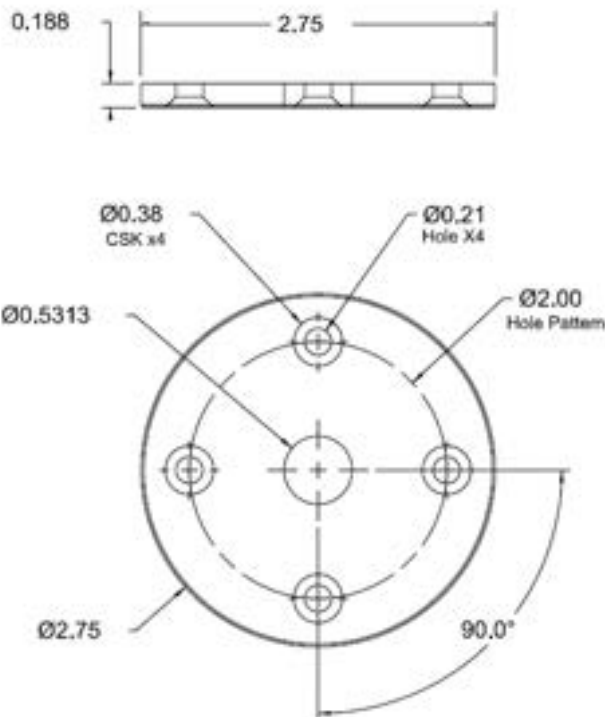

1) Finish: Polished.

2) Material: 6061-T6 Aluminum



FR0054

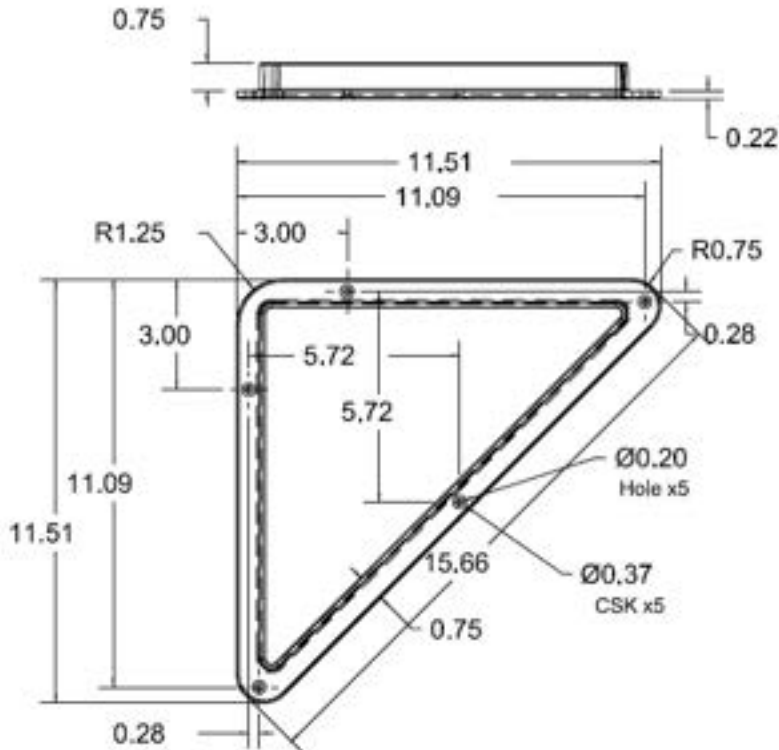

FR0054

Wheel Chock Flange Trim

1) Finish: Polished.



FR1004

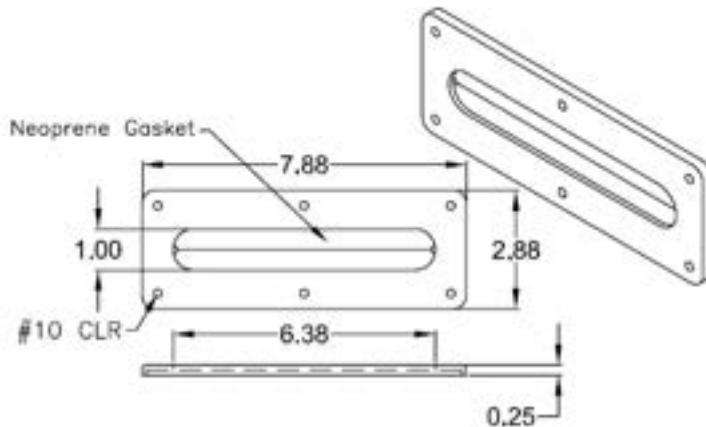

FR1004
Slot Plate with Gasket (6 3/8" Inside Length)

- 1) Designed to use a single neoprene gasket (slit down the center) to "capture" the rod and seal around the rod handle.
- 2) Finish: Polished or 120 grit directional ground. Neoprene gasket is black.

FR101294021

FR101294021
Leftside Panel
Suction Ring

- 1) Finish: Exterior flange is polished.
- 2) Material: AL 6061

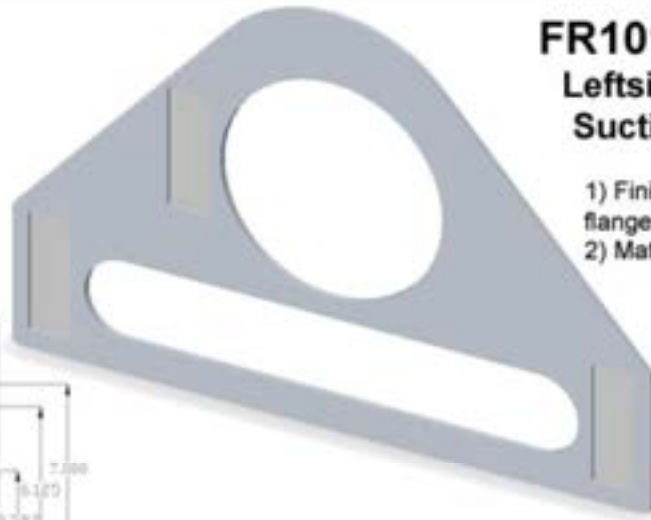
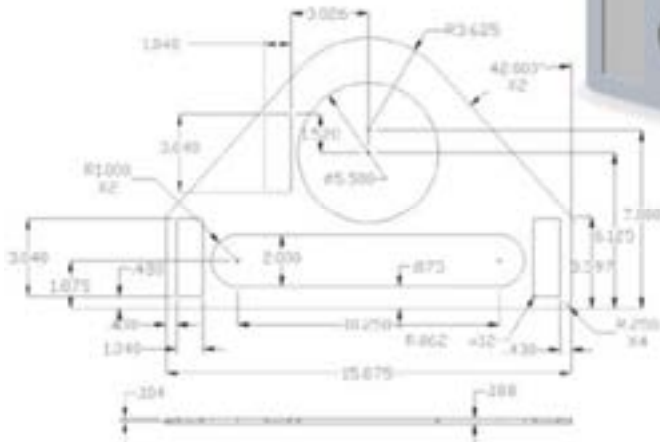

FR101294022

FR101294022
Rightside Panel
Suction Ring

- 1) Finish: Exterior flange is polished.
- 2) Material: AL 6061

